

# Product Environmental Aspects Declaration



EP and IJ printer (PCR-ID:AD-04)

No. AD-17-E940  
Date of publication  
Jun./30/2017



## SP 8400DN

【 Part # 408063 】

1. **Printing Process** : Electrophotography (EP)
2. **Color** : Monochrome
3. **Print Speed** : 60 prints/minute ( A4 / 8<sup>1</sup>/<sub>2</sub> x 11 )
4. **Maximum Paper Size** : 11 x 17 ( Trays 1-4 ),  
12 x 18 ( Bypass tray )
5. **Functions included in LCA** : Automatic Duplexing Unit

Use stage conditions:

Period of use : 5 years, Amount of use : 2,150,400 pages

※ The warming load of the use stage does not include environmental impact originated from printing paper, as specified in the PCR.



Environment Contact:  
RICOH Company, Ltd.  
Corporate Communication Center  
email : envinfo@ricoh.co.jp

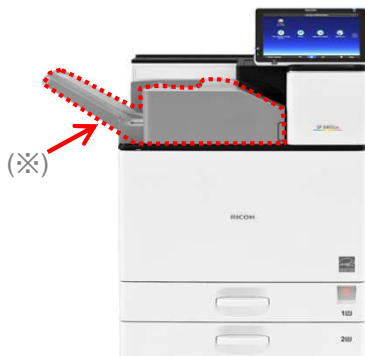

The photo shows the product with an optional Internal Multi-Folding unit (※) attached. The environmental load of the optional unit is not included in this calculation.

Consumption and discharge in a life cycle	All the stage sum totals
Global Warming (CO <sub>2</sub> equivalent)	1330kg (1250kg)
Acidification (SO <sub>2</sub> equivalent)	2.22kg (2.12kg)
Energy resources (crude oil equivalent)	27.1GJ (25.3GJ)

※Figures in ( ) indicated environmental impact including recycle effect \*note3

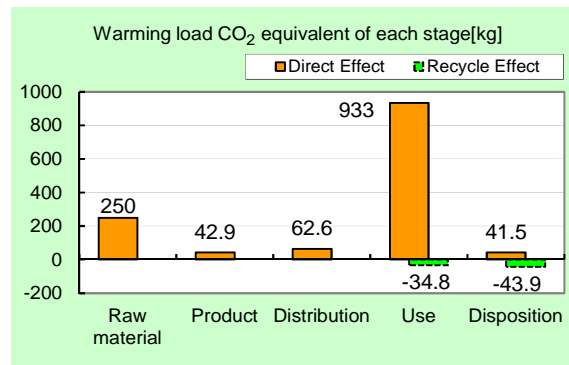

Notes:

1. Original LCA data is available on PEIDS: Product Environmental Information Declaration Sheet, and Product Data Sheet.
2. Unified rules and requirements for EcoLeaf LCA, for intended product category, are available as a PCR: Product Category Rule. Visit EcoLeaf website under JEMAI homepage at <http://www.ecoleaf-jemai.jp/eng/> for details.
3. Recycle Effect illustrates an indirect influence to other products/services.
4. Basic Units used for calculations are based on Japan domestic data at this time, due to a lack of base data to establish localized Basic Unit for overseas locations adequately.
5. This declaration was produced using Product Category Rule intended for a product model sold in the Japanese market and using the qualitative and quantitative data collected in Japan.

[Supplemental environmental information]

- Certified regulations: International Energy Star Program, EU RoHS.
- This product and its main components such as photoreceptor, toner, and carrier are produced in our factories certified to ISO14001 management system standard.

PCR review was conducted by: PCR Deliberation Committee, January 01, 2008, Name of representative: Youji Uchiyama, University of Tsukuba, Graduate School

Independent verification of the declaration and data, according to ISO14025  internal  external

Third party verifier \* : Kazuo Naito, system certification auditor

Programme operator: Japan Environmental Management Association for Industry, [ecoleaf@jemai.or.jp](mailto:ecoleaf@jemai.or.jp)

\* In the case of an business entity certified as an Ecoleaf-data-collection system, the names of certification auditors are written.

The EcoLeaf is an environmental labeling program that belongs to the ISO-Type III category.

## Product Environmental Information Data Sheet (PEIDS)



Document control no.	F-02Bs-02
Product vendor	RICOH COMPANY, LTD.
EcoLeaf registration no.	AD-17-E940

Unit Function DB version	v2.1
Characterization Factor DB version	v2.1

PCR name	EP and IJ printer		Product type	SP 8400DN [ Part # 408063 ]			
PCR code	AD-04	Product weight (kg)	56.9	Package (kg)	15.4	Weight total (kg)	72.3

In/Out items	Life Cycle Stage	Unit	Production		Distribution	Use	Disposition	Recycle Effect			
			Raw material	Product							
Energy Consumption			MJ	4.79E+03	7.90E+02	8.48E+02	2.06E+04	5.12E+01	-1.81E+03		
			Mcal	1.14E+03	1.89E+02	2.02E+02	4.92E+03	1.22E+01	-4.32E+02		
Inventory analyses	Impact by Resource Consumption	Energy resources	Coal	kg	3.47E+01	5.31E+00	1.98E-03	8.02E+01	2.87E-01	-1.33E+01	
			Crude oil (for fuel)	kg	4.37E+01	6.15E+00	1.85E+01	1.92E+02	5.86E-01	-9.49E+00	
			LNG	kg	7.26E+00	2.94E+00	2.86E-01	4.81E+01	1.49E-01	-7.53E-01	
			Uranium content of an ore	kg	6.80E-04	3.59E-04	1.34E-07	4.36E-03	1.94E-05	1.41E-05	
			Crude oil (for material)	kg	2.39E+01	0	0	6.67E+01	0	-2.07E+01	
			Iron content of an ore	kg	2.73E+01	0	0	1.63E+01	0	-1.50E+01	
			Cu content of an ore	kg	7.40E-01	0	0	2.56E-01	0	-4.49E-01	
			Al content of an ore	kg	4.72E-01	0	0	9.95E-01	0	-5.58E-01	
			Ni content of an ore	kg	1.64E-01	0	0	8.51E-03	0	-3.06E-04	
			Cr content of an ore	kg	2.32E-01	0	0	1.71E-02	0	-5.58E-03	
		Mineral resources	Mn content of an ore	kg	1.71E-01	0	0	8.78E-02	0	-1.31E-02	
			Pb content of an ore	kg	6.23E-02	0	0	2.08E-02	0	-3.65E-02	
			Sn content of an ore	kg	1.59E-03	0	0	0	0	0	
			Zn content of an ore	kg	6.27E-01	0	0	2.05E-01	0	-3.59E-01	
			Au content of an ore	kg	3.24E-05	0	0	1.98E-05	0	0	
			Ag content of an ore	kg	6.82E-02	0	0	0	0	0	
			Silica Sand	kg	8.55E-01	0	0	2.65E-01	0	-2.59E-01	
			Halite	kg	1.85E+01	2.16E-03	0	2.07E+00	1.90E-02	-6.55E-02	
			Limestone	kg	5.96E+00	0	0	3.69E+00	4.13E-01	-2.56E+00	
			Natural soda ash	kg	3.61E-02	0	0	1.24E-04	0	-4.00E-03	
			Renewable resources	Wood	kg	2.16E+01	0	0	3.48E+01	0	0
				Water	kg	1.51E+04	4.39E+03	1.49E+00	8.21E+04	2.42E+02	-1.10E+03
			Impact by Emission/Discharge to the environment	to Atmosphere	CO <sub>2</sub>	kg	2.44E+02	4.25E+01	6.01E+01	9.13E+02	4.15E+01
SO <sub>x</sub>	kg	1.50E-01			3.15E-02	4.04E-02	5.82E-01	2.20E-02	-4.64E-02		
NO <sub>x</sub>	kg	3.02E-01			2.71E-02	3.49E-01	1.27E+00	5.02E-02	-8.34E-02		
N <sub>2</sub> O	kg	2.22E-02			1.43E-03	9.18E-03	7.38E-02	7.13E-05	-1.07E-02		
CH <sub>4</sub>	kg	1.81E-03			9.60E-04	3.59E-07	1.16E-02	5.19E-05	4.86E-05		
CO	kg	3.40E-02			6.24E-03	1.04E-01	2.12E-01	9.93E-03	4.48E-03		
NM VOC	kg	3.54E-03			1.88E-03	7.03E-07	2.28E-02	1.02E-04	9.49E-05		
C <sub>2</sub> H <sub>6</sub>	kg	1.10E-02			2.56E-04	9.60E-03	3.40E-02	2.38E-04	-4.38E-03		
Dust	kg	3.56E-02			1.35E-03	3.20E-02	1.06E-01	2.88E-03	-1.48E-02		
to Water system domain	BOD	kg			-	-	-	-	-	-	
	COD	kg			-	-	-	-	-	-	
	N total	kg			-	-	-	-	-	-	
	P total	kg			-	-	-	-	-	-	
	SS	kg		-	-	-	-	-	-		
	to Soil system	Unspecified Solid Waste		kg	2.23E+00	1.15E-02	0	2.70E+01	2.42E+01	-1.65E-01	
Slag		kg		1.04E+01	0	0	5.60E+00	0	-4.95E+00		
Sludge		kg		1.01E+00	0	0	2.13E+00	0	-1.20E+00		
Low level radio-active waste		kg		4.76E-04	2.51E-04	9.37E-08	3.04E-03	1.35E-05	9.88E-06		
Impact assessment	by Resource Consumption	Exhaustible resources		Energy resources (crude oil equivalent)	kg	8.02E+01	1.60E+01	1.89E+01	3.37E+02	1.11E+00	-1.88E+01
		Mineral resources (Iron ore equivalent)		kg	1.27E+04	0	0	1.61E+02	0	-1.63E+02	
	by Emission/Discharge to environment	to Atmosphere		Global Warming (CO <sub>2</sub> equivalent)	kg	2.50E+02	4.29E+01	6.26E+01	9.33E+02	4.15E+01	-7.87E+01
Acidification (SO <sub>2</sub> equivalent)				kg	3.62E-01	5.05E-02	2.85E-01	1.47E+00	5.71E-02	-1.05E-01	

[Notes for readers: EcoLeaf common rules]

## I. Stage related

A. "Production" stage is intended for two sub-stages listed below.

- "Raw material" production: consists of mining, transportation and raw material production.
- "Product" production: consists of the parts processing, assembly and installation.

B. "Distribution" stage is intended for transportation of produced product. Transportation of consumables and maintenance goods (e.g. replacement parts) for use of the product are included into "Use" stage.

C. "Use" stage is intended for use of the product (active mode, standby mode, etc.) and production, transportation to disposal/recycle of consumables/maintenance goods (e.g. replacement parts).

D. "Disposition/Recycle" stage is intended for environmental impacts by product disposition/recycle, and deduction by recycling (e.g. impact reduction of raw material production).

E. "Recycle Effect" illustrates an indirect environmental influences to other products/services by use of reclaimed materials/parts, and/or by supply of used products to other businesses for material reclaim/parts reuse.

- Case 1: Use of reclaimed materials/parts: Sum of increase of environmental impact by collection activities of used materials/parts, and decrease by volume reduction of used materials/parts.  
Case 2: Supply of used products to other businesses for material reclaim/parts reuse: Sum of increase of environmental impact by materials/parts reclaiming process, and decrease by volume reduction of new materials/parts production.

## II. Inventory analyses

A. Data of mineral ore on "Exhaustible resources" are presented in weight of pure ingredients (e.g. iron, aluminum) in the ore.

B. Data on energy resources are presented based on origin in calorific value. e.g. Data on uranium ore presents weight of uranium concentrate, which is available for use as an atomic fuel.

C. Data of discharge to water system are in actual figure (not calculated using unit function in inventory analyses).

## III. Impact analyses

Result of the "Impact analyses" is found in converting results of inventory analyses into total amount of a reference material (e.g. CO<sub>2</sub> in case of "Global Warming").

A. Impact "by resource consumption" represents magnitude of impacts to resource depletion.

B. Impact "by emission/discharge to environment" represents magnitude of impacts to Atmosphere, Water and Soil system.

## IV. Data entry format

A. Exponential notation, after the decimal point to two, should be used.

B. Indicate "0" instead exponential notation, if the result of calculation or estimation is considered as "zero" or negligible in comparison to related results.

C. Indicate "-" if calculation nor estimation can not be done, in order to differentiate to indicate "zero".

(BGD for material production are for production from mineral ore. Those data do not include reclaiming processes like recovery from scrap.)

[Notes for readers: Target product specific]

This declaration was produced using Product Category Rule intended for a product model sold in the Japanese market and using the qualitative and quantitative data collected in Japan.

## Product data sheet

(Input data and parameters for LCA)



Document control no.	F-03s-02
Product vendor	RICOH COMPANY, LTD.
EcoLEaf registration no.	AD-17-E940

PCR name	EP and IJ printer ( PCR-ID : AD-04 )	Product type	SP 8400DN [ Part # 408063 ]				
LCA/LCIA in units of:	1 product	Product weight (kg)	56.9	Package (kg)	15.4	Weight total (kg)	72.3

### 1. Product information (per unit): parts etc. by material and by process/assembly method

Product	Breakdown of primary materials				Math breakdown of parts, which need to apply Processing / Assembly Base Units (Parts B, C)			
	Material name	Weight (kg)	Material name	Weight (kg)	Process name	Weight (kg)	Process name	Weight (kg)
	Stainless steel	1.04E+00	Lubricant	9.20E-03	Press molding: Iron (kg)	2.67E+01	Parts assembly (kg)	5.62E+01
Aluminum	4.47E-01	Thermoplastic resin	2.70E+01	Press molding: Nonferrous metal (kg)	2.52E+00			
Ordinary steel	2.60E+01	Thermosetting resin	7.80E-01	Injection molding (kg)	2.67E+01			
Glass	1.20E-01	Electronic circuit board	1.05E+00	Glass molding (kg)	2.77E-01			
Rubber	1.57E-01							
Other metals	2.07E+00							
Wood	6.90E+00							
Paper	6.79E+00							
Subtotal	4.35E+01	Subtotal	2.88E+01					
Total			7.23E+01	Subtotal	5.62E+01	Subtotal	5.62E+01	

Note

### 2. Production site information (per unit): Consumption and discharge/emission for production/processing/assembly within the site.

SOx and NOx should be indicated in SO<sub>2</sub>, NO<sub>2</sub> equivalent.

Consumption	Classification	Energy	Energy	Energy	Material	Energy	Material		
	Distribution	Electricity (kWh)	Furnace urban gas (13A) (m <sup>3</sup> )	Kerosene as fuel (kg)	Clean water (kg)	Furnace LNG (kg)	Industrial water (kg)		
	Quantity	2.03E+01	3.47E-01	1.23E-01	8.33E+01	1.05E-02	2.69E+02		
Note									
Emission/Discharge	Classification	Water system							
	Distribution	Sewage processing (kg)							
	Quantity	3.72E+02							
Note									

Note

### 3. Distribution stage information (per unit): means, distance, loading ratio, consumptions and emissions/discharges.

Distribution	Means of transportation	Diesel truck: 20 ton (kg·km)	Diesel truck: 20 ton (kg·km)	Diesel truck: 20 ton (kg·km)	Diesel truck: 20 ton (kg·km)	Freight by ship (kg·km)	Freight by ship (kg·km)	Freight by ship (kg·km)	Freight by ship (kg·km)
	Conditions	Mass(kg)	Distance (km)	Loading Ratio(%w)	Load(kg·km)	Mass(kg)	Distance (km)	Loading Ratio(%w)	Load(kg·km)
	Quantity	7.23E+01	1.28E+03	3.46E+01	2.67E+05	7.23E+01	1.16E+04	1.00E+02	8.38E+05
Note									

Note

### 4. Use stage (per unit): use condition (mode, term) including active mode, standby mode and maintenance.

#### 4.1 Product and accessories subject to this analysis

Product	Classification	Consumption	Consumption	Consumption	Consumption	Consumption	Consumption	Consumption	Consumption
	Distribution	Stainless steel plate (kg)	Aluminum plate (kg)	Glass (kg)	Styrene-butadiene rubber (SBR) (kg)	Copper plate (kg)	Zinc (kg)	Gold (kg)	Corrugated cardboard (kg)
	Quantity	5.18E-02	9.41E-01	1.48E-03	6.08E-01	8.48E-01	7.30E-04	1.98E-05	1.64E+01
Note									
Product	Classification	Consumption	Consumption	Consumption	Consumption	Consumption	Consumption	Condition	Consumption
	Distribution	Lubricant (kg)	ABS (kg)	PA66 (Polyamide 66) (kg)	Polycarbonate (kg)	Polycarbonate-ABS (70/30) (kg)	High density polyethylene (kg)	Diesel truck: 20 ton (kg·km)	Low density polyethylene (kg)
	Quantity	1.58E-03	5.18E-01	4.16E-03	2.40E-01	1.49E+00	1.50E+01	1.59E+05	1.00E+00
Note									
Product	Classification	Consumption	Consumption	Consumption	Consumption	Condition	Consumption	Consumption	Consumption
	Distribution	PET (kg)	POM (polyacetal) (kg)	Polypropylene (kg)	Polystyrene (kg)	Freight by ship (kg·km)	Epoxy resin (EP) (kg)	Expandable hard polyurethane (Hard) (kg)	Expandable soft polyurethane (for automobile)
	Quantity	6.07E+01	2.03E+00	4.85E-03	6.73E+00	8.93E+05	1.29E-02	1.74E-02	2.58E-02
Note									
Product	Classification	Consumption	Consumption	Consumption	Condition	Consumption	Consumption	Consumption	Consumption
	Distribution	Unsaturated polyester (UP) (kg)	Assembled circuit board (kg)	Electroplated steel Plate (kg)	Diesel truck: 20 ton (kg·km)	Cold-Rolled steel plate (kg)	Press molding: Iron (kg)	Press molding: Nonferrous metal (kg)	Injection molding (kg)
	Quantity	1.12E-01	2.78E-05	2.87E+00	8.43E+03	1.28E+01	1.17E+01	1.79E+00	2.72E+01
Note									

Product	Classification	Condition	Consumption	Consumption	Energy	Energy	Energy	Condition	Material
	Distribution	Freight by ship (kg·km)	Glass molding (kg)	Parts assembly (kg)	Electricity (kWh)	Furnace urban gas (13A) (m <sup>3</sup> )	Kerosene as fuel (kg)	Diesel truck: 20 ton (kg·km)	Clean water (kg)
	Quantity	4.75E+04	6.10E-01	4.13E+01	3.84E+02	4.51E+00	1.60E+00	8.49E+04	1.62E+02
	Note								
	Classification	Energy	Material	Water system	Consumption	Consumption	Condition		
	Distribution	Furnace LNG (kg)	Industrial water (kg)	Sewage processing (kg)	Electricity (kWh)	Gasoline as fuel (kg)	Freight by ship (kg·km)		
	Quantity	6.07E-01	6.72E+01	4.90E+02	6.24E+02	9.53E+00	4.78E+05		
Note									

Note

#### 4.2 Disposition/Recycle information on consumables and replacement parts

Consumables	Classification	Process	Process	Process	Process	Process	Process	Process	Process
	Distribution	Landfill: Industrial waste (kg)	Landfill: General waste (kg)	Incineration to landfill (as ash) (kg)	Diesel truck: 4 ton (kg·km)	Shredding (kg)	Sorting: Iron (by magnetic force) (kg)	Sorting: Nonferrous metal (by eddy current with wind force) (kg)	Sorting: Plastics (by relative density difference in water) (kg)
	Quantity	5.02E+00	1.42E+01	3.30E+01	4.57E+03	5.14E+01	2.06E+01	1.61E+01	1.54E+01
	Note								
	Classification	Process	Process	Process	Process	Process	Deduction	Deduction	Deduction
	Distribution	Recycle: to Glass (kg)	Recycle: to cold-rolled steel (kg)	Recycle: to Aluminum plate (kg)	Recycle: to copper plate (kg)	Recycle: to Thermoplastic pellet (kg)	Glass (kg)	Cold-Rolled steel plate (kg)	Aluminum plate (kg)
	Quantity	5.90E-04	4.48E+00	3.61E-01	3.26E-01	1.04E+01	5.78E-04	4.48E+00	3.61E-01
	Note								
	Classification	Deduction	Deduction	Process					
	Distribution	Copper plate (kg)	Polystyrene (kg)	Diesel truck: 10 ton (kg·km)					
Quantity	3.26E-01	1.04E+01	1.65E+04						
Note									

Note

#### 5. Disposition/Recycle stage information (per product): process method and scenarios

Scenario	Classification	Process	Process	Process	Process	Process	Process	Process	Deduction
	Distribution	Landfill: Industrial waste (kg)	Landfill: General waste (kg)	Incineration: Industrial waste (kg)	Incineration to landfill (as ash) (kg)	Shredding (kg)	Diesel truck: 10 ton (kg·km)	Diesel truck: 4 ton (kg·km)	High density polyethylene (kg)
	Quantity	1.25E+00	1.84E+01	6.09E-01	2.94E+01	6.60E+01	2.11E+04	4.36E+03	3.26E-01
	Note								
	Classification	Process	Process	Process	Process	Process	Process	Process	Process
	Distribution	Sorting: Iron (by magnetic force) (kg)	Sorting: Nonferrous metal (by eddy current with wind force) (kg)	Sorting: Plastics (by relative density difference in water) (kg)	Recycle: to Glass (kg)	Recycle: to cold-rolled steel (kg)	Recycle: to Aluminum plate (kg)	Recycle: to copper plate (kg)	Recycle: to Thermoplastic pellet (kg)
	Quantity	2.27E+01	1.26E+01	1.17E+01	4.81E-02	1.00E+01	1.67E-01	1.16E+00	1.04E+01
	Note								
	Classification	Deduction	Deduction	Deduction	Deduction	Deduction			
	Distribution	Glass (kg)	Cold-Rolled steel plate (kg)	Aluminum plate (kg)	Copper plate (kg)	Polystyrene (kg)			
Quantity	4.71E-02	1.00E+01	1.67E-01	1.16E+00	1.01E+01				
Note									

Note

#### 6. Others

This declaration was produced using Product Category Rule intended for a product model sold in the Japanese market and using the qualitative and quantitative data collected in Japan.